



Feel The Touch

RINSE

Away Your Worries
In Our Sink.

QUARTZ KITCHEN SINK



DIMENSIONS

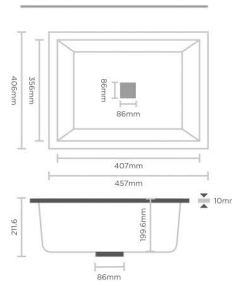

THICKNESS

10MM

SINGLE BOWL

INFORMATION

Size	16x18x8.5 Inch (406.4x457.2x215.9mm)
Weight	8.0 kgs. (Approx)
Finish	Granite, Metallic
Accessories	Waste Coupling, Drainage Pipe
MRP	4500/-



DIMENSIONS

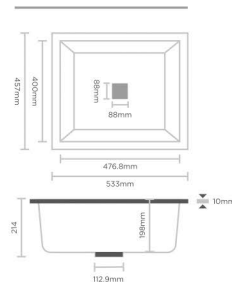

THICKNESS

10MM

SINGLE BOWL

INFORMATION

Size	21x18x8.5 Inch (533.4x457.2x215.9mm)
Weight	10.0 kgs. (Approx)
Finish	Granite, Metallic
Accessories	Waste Coupling, Drainage Pipe
MRP	5000/-



DIMENSIONS

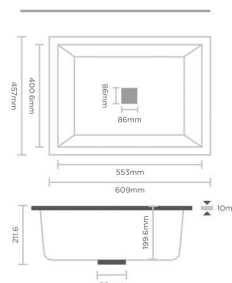

THICKNESS

10MM

SINGLE BOWL

INFORMATION

Size	24x18x8.5 Inch (609.6x457.2x215.9mm)
Weight	11.5 Kgs. (Approx)
Finish	Granite, Metallic
Accessories	Waste Coupling, Drainage Pipe
MRP	5500/-



DIMENSIONS

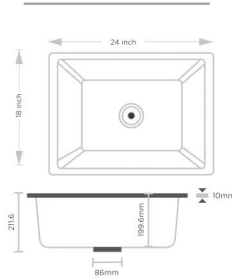

THICKNESS

10MM

SINGLE BOWL

INFORMATION

Size	24x18x10 Inch (609.6x457.2x254mm)
Weight	12.5 kgs. (Approx)
Finish	Granite, Metallic
Accessories	Waste Coupling, Drainage Pipe
MRP	6500/-



DIMENSIONS

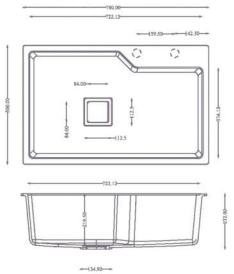

THICKNESS

10MM

SINGLE BOWL SINK WITH TAP HOLE

INFORMATION

Size	30x20x9 Inch (760x500x240mm)
Weight	16 kgs. (Approx)
Finish	Granite, Metallic
Accessories	Waste Coupling, Drainage Pipe
MRP	7000/-



DIMENSIONS

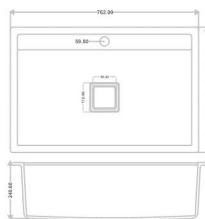

THICKNESS

10MM

SINGLE BOWL SINK WITH TAP HOLE

INFORMATION

Size	20x30x9.5 Inch (508x762x241.3mm)
Weight	17 Kgs. (Approx)
Finish	Granite, Metallic
Accessories	Waste Coupling, Drainage Pipe
MRP	7000/-



DIMENSIONS

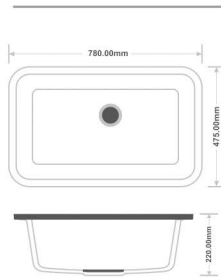

THICKNESS

10MM

SINGLE BOWL

INFORMATION

Size	31x19x9.5 Inch (787.4x482.6x241.3mm)
Weight	14 Kgs. (Approx)
Finish	Granite, Metallic
Accessories	Waste Coupling, Drainage Pipe
MRP	7000/-



DIMENSIONS

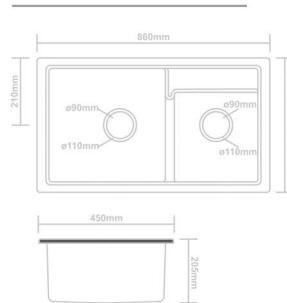

THICKNESS

10MM

DOUBLE BOWL

INFORMATION

Size	31x18x8.5 Inch (860x450x215mm)
Weight	16 kgs. (Approx)
Finish	Granite, Metallic
Accessories	Waste Coupling, Drainage Pipe
MRP	000/-

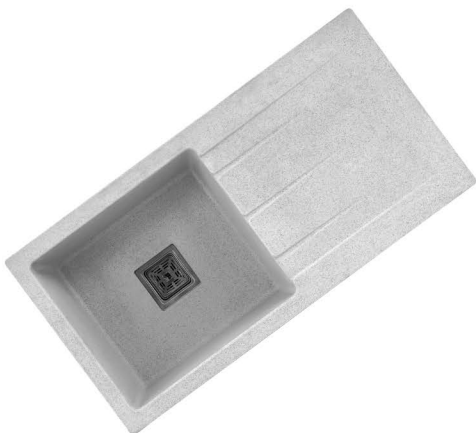

DIMENSIONS

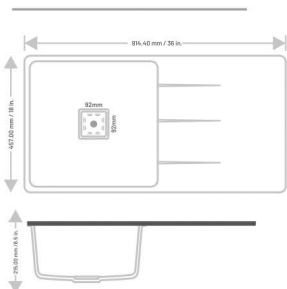

THICKNESS

10MM

DRAINBOARD

INFORMATION

Size	36x18x8.5 Inch (457x914.4x215mm)
Weight	16 kgs. (Approx)
Finish	Granite, Metallic
Accessories	Waste Coupling, Drainage Pipe
MRP	9000/-



DIMENSIONS

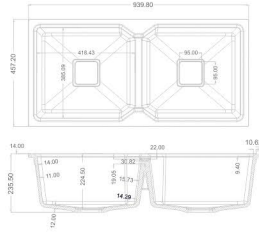

THICKNESS

10MM

DOUBLE BOWL

INFORMATION

Size	37x18x9 Inch (939.8x457.2x228.6mm)
Weight	22.00 kgs. (Approx)
Finish	Granite, Metallic
Accessories	Waste Coupling, Drainage Pipe
MRP	10000/-



DIMENSIONS

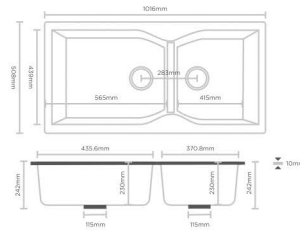

THICKNESS

10MM

DOUBLE BOWL

INFORMATION

Size	40x20x9.5 Inch (1016x508x241.3mm)
Weight	24 kgs. (Approx)
Finish	Granite, Metallic
Accessories	Waste Coupling, Drainage Pipe
MRP	11000/-



DIMENSIONS

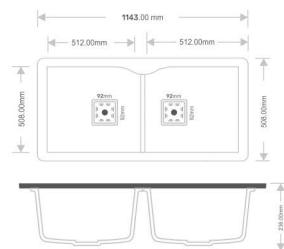

THICKNESS

10MM

DOUBLE BOWL

INFORMATION

Size	45x20x9.5 Inch (1143x508x226mm)
Weight	25.0 kgs. (Approx)
Finish	Granite, Metallic
Accessories	Waste Coupling, Drainage Pipe
MRP	12000/-



DIMENSIONS

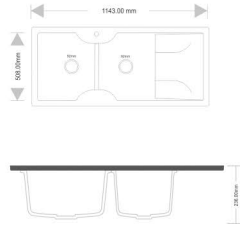

DOUBLE BOWL DRAIN BOARD

INFORMATION

Size	45x20x9 Inch (1143x508.x226mm)
Weight	26.00 kgs. (Approx)
Finish	Granite, Metallic
Accessories	Waste Coupling, Drainage Pipe
MRP	12000/-

COLOR SHADE

METALLIC
series

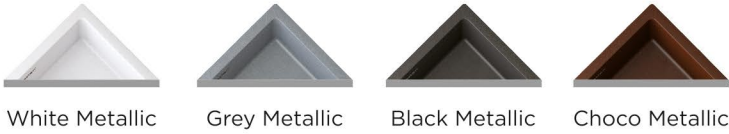

GRANITE
series



INSTALLATION



INSTALLATION SINK

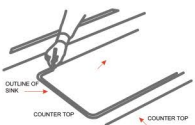

Trace the outline of the template and cut countertop according to templated outline using appropriate cutting tools. Template is for guide only. Use physical sink to ensure accurate cutout opening.

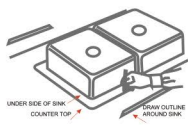

Draw a line 1cm inside the sink outline.

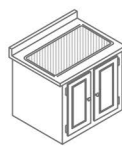

Locate the drill holes on the underside of the countertop, approximately 1" from edge of the sink to be installed. Holes should be evenly spaced approximately 6" to 8" apart starting from every corner as shown in.

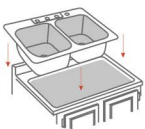

Clean sink flange and underside of cutout area of countertop, making sure that the area is smooth and free of grease.

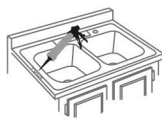

Apply continuous bead of silicone caulk evenly on top of sink flange. Position and align sink onto the countertop opening and press sink onto countertop. Turn bent end of mounting bracket to snug over the sink rim.

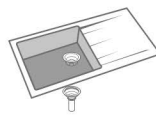

Wipe away excess silicone caulk with damp cloth. Connect drain and water supply according to manufacturer's instruction.

DRILLING TAP HOLE

Invert the Sink, Use the marking to Drill the Hole with Wood Cutting Bit

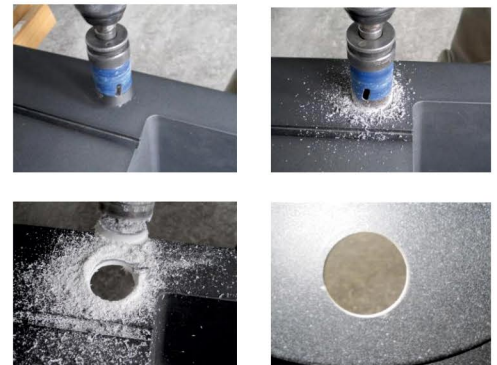



SEZON INDUSTRIES

8-A, National Highway, Op. Dariyalal Resorts,
At. Jambudiya Morbi-363 642. Dist.Morbi (Guj.) India.

sezonindsink@gmail.com
www.sezonsink.com

Customer Care : +91 98252 20026